

# Jeffrey Cooper

*Art furnishings for artful living*

135 McDonough Street • Portsmouth, NH 03801 • 603-436-7945 • jcooper@cooperwoodsculptor.com • www.CooperWoodSculptor.com

## Art Furnishings for Artful Living Newsletter

### Multipurpose Entryway Cabinet July 2015

Dear Friend,

Wednesday I am off on a two week vacation to Bolivia, for some trekking. I have been practicing my Spanish for the trip. But I'll be back next month. Meanwhile, the Furniture Masters show is up **until July 23 at Thorne Sagendorf Gallery in Keene**, the animal chairs, table and lamp will move to **The League Crafts fair at Mt Sunapee for the first week in August**, and I'll be bringing them to the **Castle in the Clouds for an evening soiree August 16**. And don't forget the **Furniture Masters Gala October 4**, when we will be reintroducing the auction with a new format. It will take place at the dinner after the open to the public hours. Pieces in the auction will have pre-bids, so if you are interested in bidding on something, not just mine but anyone's, be sure to speak up, and get your dinner tickets. More information is on the [Furniture Masters](#) web site.

**My current project is a combination piece, bench, chest of drawers and shoe storage**

This was an interesting design challenge. It is for an entry of a walk up flat, where the homeowners want to take off their shoes before heading up the stairs. And since they are downsizing, they are thinking efficient use of space. The entire structure is frame and panel, with walnut frames and curly maple panels, inspired by the photo upper right found on Google images. (Meaning, it's not my work)



These are the frame parts with the mortises cut, and dry fit

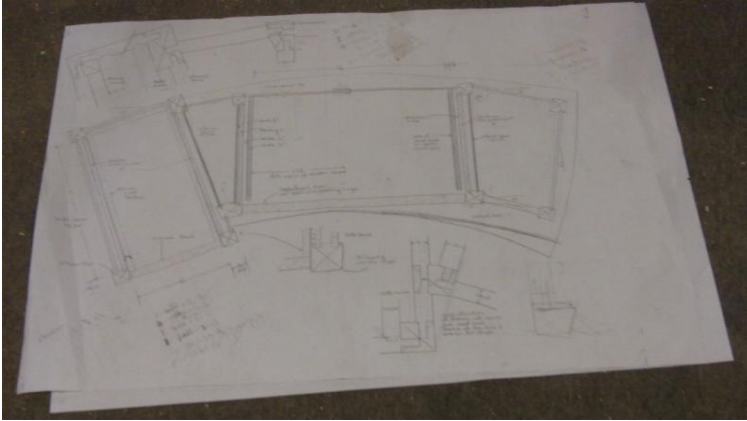

Here is another view of the frame dry fit, and the plan view drawing.

**This is the mock up of the sliding show rack** that will be beneath the bench. It will pass over a drop front door that will have a relief carved tessellated whale design.

Plus, I had to design around a window that will be behind the bench. So, to the left of the window a tall set of drawers, in the center a bench with a Nakashima-like seat back, and to the right a miniature of the tall chest of drawers will sit on the bench.

Who could think of such a thing?

It was designed with collaboration from Diane Hart, their interior designer.

For more about Diane, [click here](#)

I found it refreshing to work with Diane because she had a flair for arts, and was open for plenty of dialogue.



### **An idea for a large harvest table**

I recently came into possession of two large oak slabs, full width of the bore. I am imagining the booked matched to make a fantastic, rustic style harvest table, with a base designed just for them.

Can I interest anyone in that? It would be quite a piece. They are eight feet long.

**Next newsletter I'll have the photos of the animal chair set, and the giraffe lamp.**

That's it for now.

**Jeffrey**



---

### **Quick Links...**

To visit my website [\[click here\]](#)

To see past newsletters with more work in progress photos [\[click here\]](#)

To send me an email [\[click here\]](#)

### **Contact Information**

phone: 603 436 7945

[Join Our Mailing List!](#)

[Forward this email](#)



This email was sent to jcooper4@myfairpoint.net by [jcooper@cooperwoodsculptor.com](mailto:jcooper@cooperwoodsculptor.com) | [Update Profile/Email Address](#) | Rapid removal with [SafeUnsubscribe™](#) | [Privacy Policy](#).



Art Furnishings for Artful Living | 135 McDonough St. | Portsmouth | NH | 03801